

TIGHTENING TORQUES

(1) Special Tightening Torques

For "*" marked screws, bolts and nuts on under table, apply engine oil to their threads and seats before tightening.

<p>Cylinder head cover screw</p> 		<p>Injection pipe retaining nut</p> 		<p>Overflow pipe retaining nut</p> 	
Z482-E2B	6.86 to 11.3 N·m 0.7 to 1.15 kgf·m 5.1 to 8.3 ft-lbs	Z482-E2B	24.5 to 34.3 N·m 2.5 to 3.5 kgf·m 18.1 to 25.3 ft-lbs	Z482-E2B	19.6 to 24.5 N·m 2.0 to 2.5 kgf·m 14.5 to 18.1 ft-lbs
Z602-E2B					
D662-E2B					
D722-E2B					
D782-E2B					
D902-E2B					
<p>Nozzle holder assembly</p> 		<p>Glow plug</p> 		<p>Rocker arm bracket screw</p> 	
Z482-E2B	49.0 to 68.6 N·m 5.0 to 7.0 kgf·m 36.2 to 50.6 ft-lbs	Z482-E2B	7.85 to 14.7 N·m 0.8 to 1.5 kgf·m 5.8 to 10.8 ft-lbs	Z482-E2B	9.8 to 11.3 N·m 1.00 to 1.15 kgf·m 7.2 to 8.3 ft-lbs
Z602-E2B					
D662-E2B					
D722-E2B					
D782-E2B					
D902-E2B					
<p>Cylinder head screw</p> 		<p>Cylinder head tightening order</p> <p>(A) 2 cylinder model</p>  <p>(B) 3 cylinder model</p> 			
Z482-E2B	37.3 to 42.2 N·m 3.8 to 4.3 kgf·m 27.5 to 31.1 ft-lbs	Z482-E2B	<p>(A) 2 cylinder model a → j</p> <p>(B) 3 cylinder model a → n</p>		
Z602-E2B					
D662-E2B					
D722-E2B					
D782-E2B					
D902-E2B					

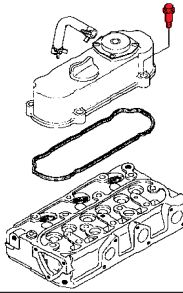
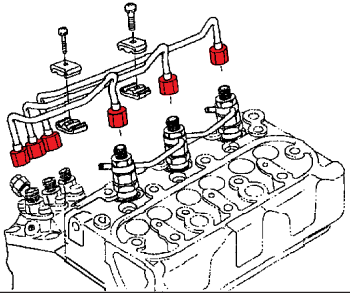
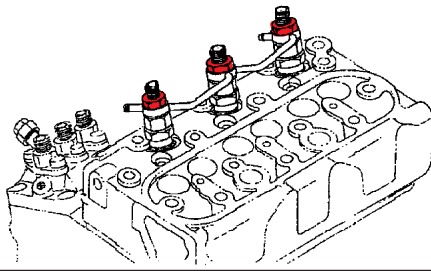
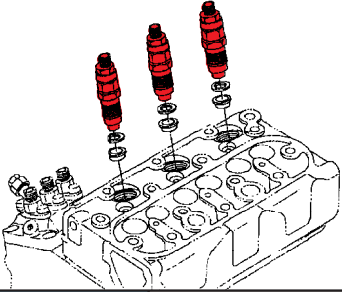
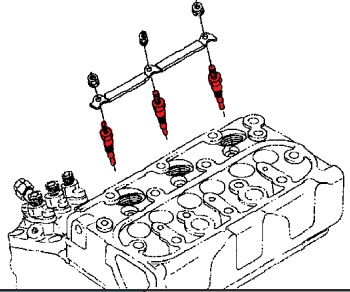
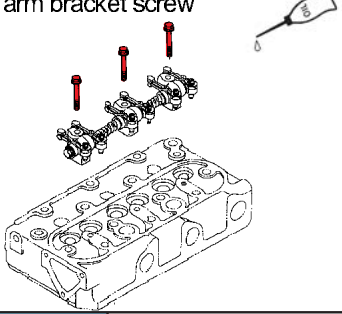
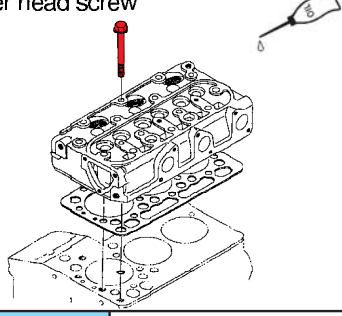
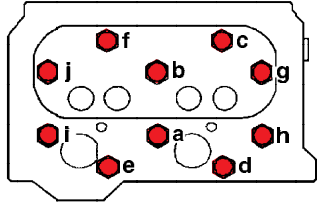
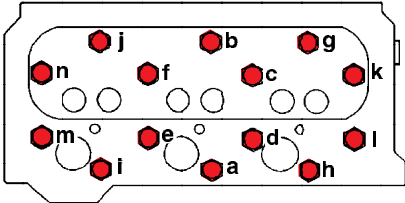
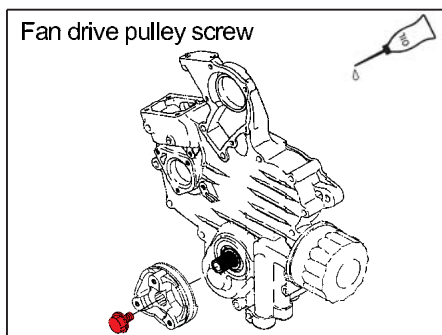

Fan drive pulley screw

Z482-E2B
Z602-E2B
D662-E2B
D722-E2B
D782-E2B
D902-E2B

98.1 to 107.9 N·m
10.0 to 11.0 kgf·m
72.3 to 79.6 ft-lbs

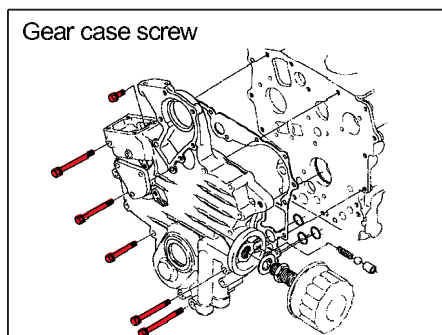

Gear case screw

Z482-E2B
Z602-E2B
D662-E2B
D722-E2B
D782-E2B
D902-E2B

9.8 to 11.3 N·m
1.00 to 1.15 kgf·m
7.2 to 8.3 ft-lbs

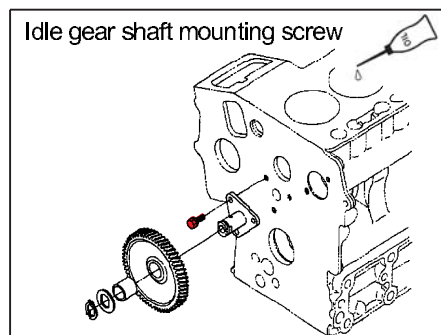

Idle gear shaft mounting screw

Z482-E2B
Z602-E2B
D662-E2B
D722-E2B
D782-E2B
D902-E2B

9.8 to 11.3 N·m
1.00 to 1.15 kgf·m
7.2 to 8.3 ft-lbs

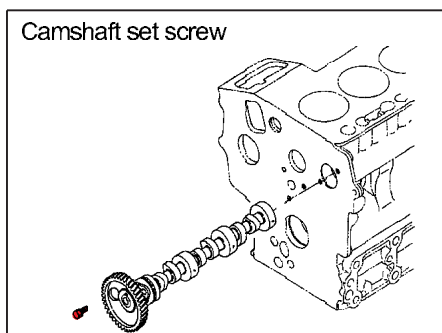

Camshaft set screw

Z482-E2B
Z602-E2B
D662-E2B
D722-E2B
D782-E2B
D902-E2B

9.8 to 11.3 N·m
1.00 to 1.15 kgf·m
7.2 to 8.3 ft-lbs

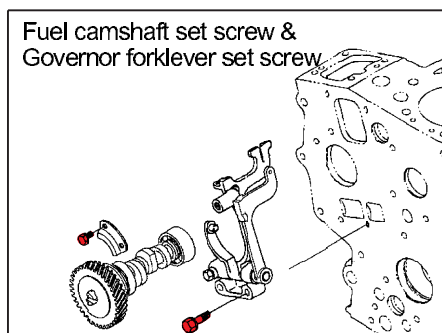

Fuel camshaft set screw & Governor forklever set screw

Z482-E2B
Z602-E2B
D662-E2B
D722-E2B
D782-E2B
D902-E2B

9.8 to 11.3 N·m
1.00 to 1.15 kgf·m
7.2 to 8.3 ft-lbs

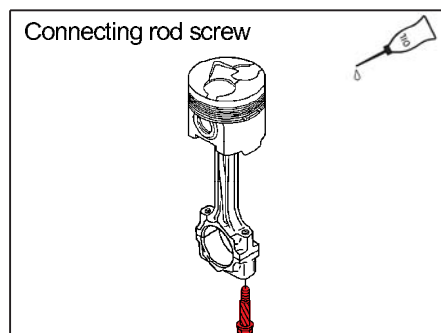

Connecting rod screw

Z482-E2B
Z602-E2B
D662-E2B
D722-E2B
D782-E2B
D902-E2B

26.5 to 30.4 N·m
2.7 to 3.1 kgf·m
19.5 to 22.4 ft-lbs

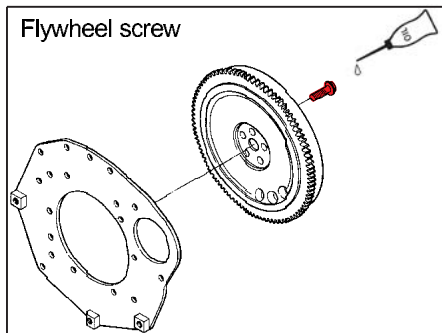

Flywheel screw

Z482-E2B
Z602-E2B
D662-E2B
D722-E2B
D782-E2B
D902-E2B

53.9 to 58.8 N·m
5.5 to 6.0 kgf·m
39.8 to 43.4 ft-lbs

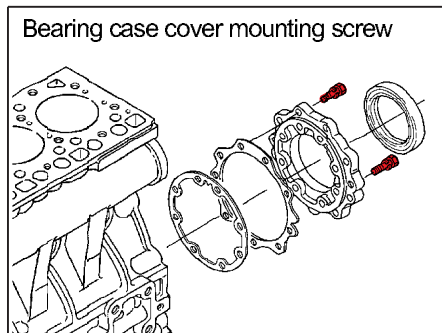

Bearing case cover mounting screw

Z482-E2B
Z602-E2B
D662-E2B
D722-E2B
D782-E2B
D902-E2B

9.8 to 11.3 N·m
1.00 to 1.15 kgf·m
7.2 to 8.3 ft-lbs

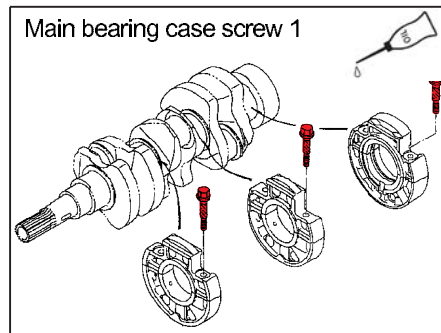

Main bearing case screw 1

Z482-E2B
Z602-E2B
D662-E2B
D722-E2B
D782-E2B
D902-E2B

12.7 to 15.7 N·m
1.3 to 1.6 kgf·m
9.4 to 11.6 ft-lbs

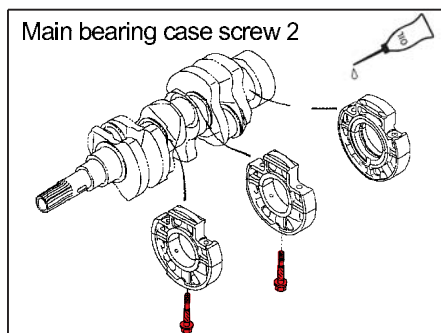

Main bearing case screw 2	
Z482-E2B	
Z602-E2B	
D662-E2B	26.5 to 30.4 N·m
D722-E2B	2.7 to 3.1 kgf·m
D782-E2B	19.5 to 22.4 ft-lbs
D902-E2B	

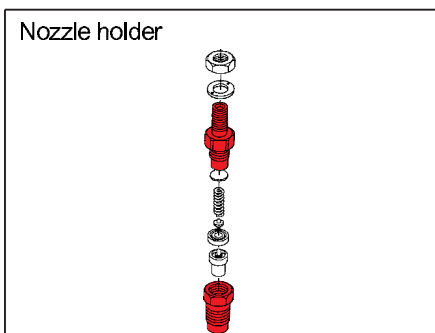

Nozzle holder	
Z482-E2B	
Z602-E2B	
D662-E2B	34.3 to 39.2 N·m
D722-E2B	3.5 to 4.0 kgf·m
D782-E2B	25.3 to 28.9 ft-lbs
D902-E2B	

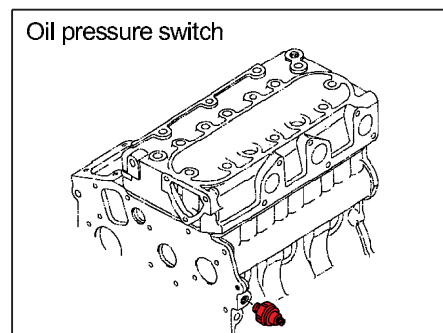

Oil pressure switch	
Z482-E2B	
Z602-E2B	
D662-E2B	14.7 to 19.6 N·m
D722-E2B	1.5 to 2.0 kgf·m
D782-E2B	10.8 to 14.5 ft-lbs
D902-E2B	

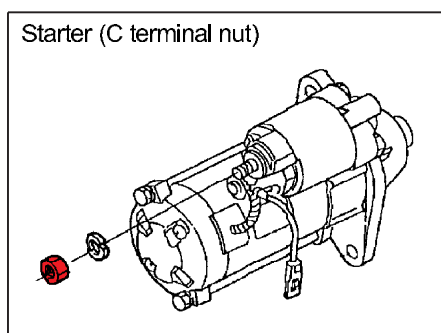

Starter (C terminal nut)	
Z482-E2B	
Z602-E2B	
D662-E2B	5.9 to 11.8 N·m
D722-E2B	0.6 to 1.2 kgf·m
D782-E2B	4.3 to 8.7 ft-lbs
D902-E2B	

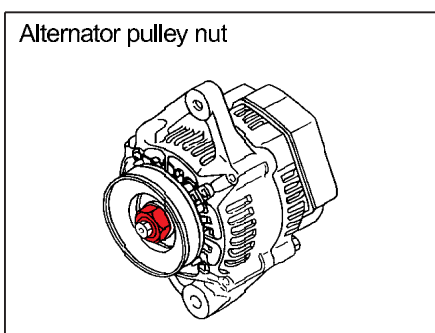

Alternator pulley nut	
Z482-E2B	
Z602-E2B	
D662-E2B	58.3 to 78.9 N·m
D722-E2B	5.95 to 8.05 kgf·m
D782-E2B	43.0 to 58.2 ft-lbs
D902-E2B	

(2) General Tightening Torques

Screw and bolt material grades are shown by numbers punched on the screw and bolt heads.

Prior to tightening, be sure to check out the numbers as shown below.

None or 4 : Standard grade

7 : Special grade

Nominal Diameter	Standard Grade	Special Grade
M6	7.9 to 9.3 N·m 0.80 to 0.95 kgf·m 5.8 to 6.9 ft-lbs	9.8 to 11.3 N·m 1.00 to 1.15 kgf·m 7.23 to 8.32 ft-lbs
M8	17.7 to 20.6 N·m 1.8 to 2.1 kgf·m 13.0 to 15.2 ft-lbs	23.5 to 27.5 N·m 2.4 to 2.8 kgf·m 17.4 to 20.3 ft-lbs
M10	39.2 to 45.1 N·m 4.0 to 4.6 kgf·m 28.9 to 33.3 ft-lbs	48.1 to 55.9 N·m 4.9 to 5.7 kgf·m 35.4 to 41.2 ft-lbs
M12	62.8 to 72.6 N·m 6.4 to 7.4 kgf·m 46.3 to 53.5 ft-lbs	77.5 to 90.2 N·m 7.9 to 9.2 kgf·m 57.1 to 66.5 ft-lbs