

FRONT DRIVE SHAFTS

All Models

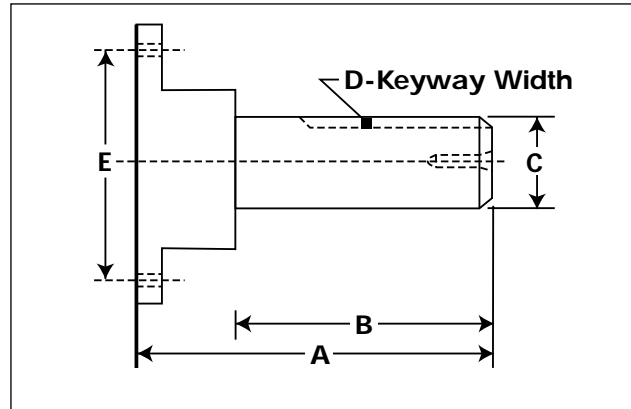

FRONT DRIVES (DIMENSIONS IN INCHES)

Part No.	A	B	C	D	E	Hardware Required	D & T	Model*
52 144 19-S	4.66	2.53	1.0	.25	3.0	See Below	3/8-16	CH11-15, TH520-575, LH630-760
235954-S	3.48	1.44	1.0	.25	3.0	See Below	3/8-16	CH11-15, TH520-575, LH630-760
237350-S	4.66	2.41	1.125	—	3.0	See Below	—	CH11-15, TH520-575, LH630-760
47 144 01-S	3.88	1.75	1.125	.25	3.0	See Below	7/16-20	CH11-15, TH520-575, LH630-760
47 144 09-S	3.88	1.75	1.0	.25	3.0	See Below	7/16-20	CH11-15, TH520-575, LH630-760
52 144 07-S	3.80	1.80	1.0	.25WD	3.0	See Below	—	CH11-15, TH520-575, LH630-760
24 755 05-S	7.00	1.44	1.0	.25	3.0	See Below	3/8-16	CH18-26/730-745, TH520-575, LH630-760
24 755 06-S	7.00	1.76	1.0	.25	3.0	See Below	7/16-20	CH18-26/730-745, TH520-575, LH630-760
24 755 07-S	7.00	1.80	1.0	.25	3.0	See Below	—	CH18-26/730-745, TH520-575, LH630-760
24 755 08-S	7.00	2.53	1.0	.25	3.0	See Below	3/8-16	CH18-26/730-745, TH520-575, LH630-760
24 144 13-S	6.40	2.53	1.0	.25	3.0	See Below	3/8-16	CH18-26/730-745, TH520-575, LH630-760
24 144 16-S	5.35	2.53	1.0	.25	3.0	See Below	—	CH18-26/730-745, TH520-575, LH630-760
24 144 17-S	4.00	1.93	0.7**	.188WD	3.0	See Below	—	CH18-26/730-745, TH520-575, LH630-760
24 144 22-S	6.20	2.60	1.125	.25	3.0	See Below	—	CH18-26/730-745, TH520-575, LH630-760
24 144 23-S	4.84	2.82	1.0	.25	3.0	See Below	3/8-16	CH18-26/730-745, TH520-575, LH630-760
24 144 25-S	5.51	2.17	1.0	.25	3.0	See Below	—	CH18-26/730-745, TH520-575, LH630-760
24 144 26-S	3.94	1.06	0.625	.187	3.0	See Below	—	CH18-26/730-745, TH520-575, LH630-760
24 144 32-S	8.23	3.79	1.0	.25	3.0	See Below	M12 x 1.75	CH18-26/730-745, TH520-575, LH630-760
28 144 05-S	5.28	3.07	1.125	.25	3.0	See Below	—	TH520-575, LH630-760
66 144 04-S	3.87	2.37	1.125	.25	3.0	See Below	—	LH630-760

* Consult factory on: **CH11-15** since flywheel holes may vary and spec may not accept front drive. **LH630-760** to verify front loading.

**Threaded end (3/4"-16 UNF-2A).

WD = Woodruff Key

Required Hardware

CH11-15 (2) X-22-2-S Washer, (2) M-1053030-S Screw. **CH18-26/730-745** (4) M-839025-S Screw (Included in -755 kits). **TH520-575, LH630-760** (4) M-839025-S Screw.

WHEN ADDING FRONT DRIVES...

LH630-760: Also order 66 096 18-S Flywheel Cover w/ hole for front drive... or instruction sheet TT-5081 for a template to cut the hole in your existing flywheel cover. **All other models:** Also order Grass Screen w/ hole for front drive per table below. If changing from plastic screen to metal screen, also order blower housing: **CH18-20**, order housing 24 027 184-S. **CH22-25/730-740**, order housing 24 027 185-S. **CH26/745**, order housing 24 027 123-S. **TH520-575**, order housing 28 027 09-S. Must also order write-on nameplate 41 037 10-S if changing blower housing.

Grass Screen Part No.	Type	Hole Dia. (In.)	Hardware Required To Attach New Screen	Model
12 162 03-S	Plastic	2.56	None	CH11-15
24 162 16-S	Plastic	1.42	(4) M-639016-S Screw, (4) 12 112 01-S Spacer	CH18-22
24 162 18-S	Plastic, Hi-Eff.	1.77	None	CH18-26/730-745, TH520-575
24 162 22-S	Metal*, Flat	1.57	None*	CH18-26/730-745, TH520-575
24 162 23-S	Metal*, Flat	2.95	None*	CH18-26/730-745, TH520-575
24 162 24-S	Metal*, Flat	2.46	None*	CH18-26/730-745, TH520-575

*Flat design. If replacing older "crowned" version, also order 54 755 10-S Hardware Kit.